



13X



26X

FEATURES

Easy to Operate. Unskilled Workers can learn to Sharpen the Drills quickly. Economical Price combined with fast grinding and accuracy Diamond Grinding Wheel. Low Maintenance whilst providing high quality results. Motors are electronic, powerful and have a good frequency stability for longer life.

SPECIFICATIONS

BRIERLEY13X

Drill Size	Dia.3 ~ Dia.13mm
Point Angle	118° ~ 135°
Power Supply	Single phase 110v AC 220v
Motor	¼ hp 180w
RPM of motor	5,300rpm
Diamond Grinding Wheel	CBN#200
Weight	9.5kg
Machine Dimensions	310x170x190mm

STANDARD ACCESSORIES

Collet: Dia.3, 4, 5, 6, 7, 8, 9, 10, 11, 12, 13mm Collet holder set Hexagon wrench 4mm

DRILL GRINDING PROCEDURE

A. HOW TO HOLD A DRILL BIT IN COLLET AND HOLDER

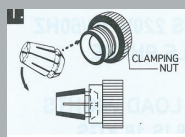

Collet must be assembled into the clamping nut at a 45° angle.

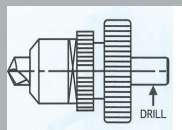

Holder Unit

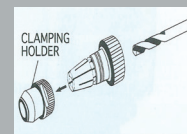

1. Insert the drill into the collet
2. Put the clamping nut into the clamping holder

B. HOW TO SET THE HOLDER UNIT AT THE CHECKING STOCK

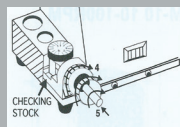

1. Find the drill diameter
 2. Set the indicator of scale number is same as drill diameter.
 3. Put the holder unit into the checking stock. The slot of clamping unit will match into the pin of checking stock.
 4. Turn holder unit to right.
 5. Push the drill to touch the checking stock and turn the drill to right. Then tighten the clamping nut to the drill.
- NOTE: Make sure that the web blade of drill is parallel with the slot of clamping holder.
6. After having taken out the holder unit

C. HOW TO GRIND THE WEB OF DRILL

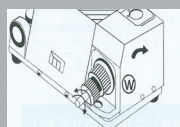

1. Turn on the power
2. Put the holder unit into the (W) grinder stock. The slot match with the pin and let the drill reach the diamond wheel carefully.
3. Grind the drill by moving left and right to sharpen until the grinding noise disappears.
4. Take the holder unit to the other side to grind the other side web, blade. Grind the drill as in No.3.

D. HOW TO GRIND THE CENTRE POINT OF DRILL

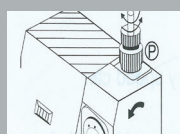

1. Turn on the power.
 2. Put the holder unit into the (P) grinder stock and match the slot with the pin.
 3. Move the left and right way to sharpen.
 4. Turn 180° of holder unit to grinding the other sides with the same way.
- NOTE: under Ø3 drill not need to grind the centre point.

E. HOW TO CHANGE THE DIAMOND WHEEL

1. Take out the diamond wheel cover.
2. Turn out the screw on the centre of diamond wheel

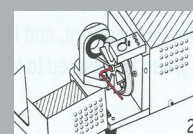
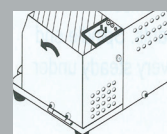

FEATURES

Easy to operate, Unskilled workers can learn to sharpen the drills quickly. Economical price, grinding fast and high accuracy. Diamond grinding wheel. Low maintenance, good grinding result. Motor is electronic and powerful, frequency stably, extra motor life

BRIERLEY 26X

Drill Size	12 ~ 26mm
Point Angle	100° ~ 135°
Power Supply	Single phase 220v
Motor	¼ hp 180w
RPM of Motor	5300rpm
Diamond Grinding Wheel	CBN #200
Weight	23kg
Machine Dimensions	460x240x220mm

STANDARD ACCESSORIES

Collet: 13, 14, 15, 16, 17, 18, 19, 20, 21, 22, 23, 24, 25, 26 Collet holder set / Hexagon wrench 4mm